

Part N^o 176210 EMP / Lightning Protector – Gas Capsule

Features

- Replaceable Gas Capsules
- Very competitively priced
- Bulk Head Design for Panel Mounting
- Weather proof “O” Ring Seal to panel and capsule cover
- Broadband use for most applications DC-2.5 GHz
- Suitable for RF Power Systems upto 600W
- Supplied with Earthing lug and Mounting bracket
- Premium Quality Plating Throughout, Cu-Sn-Zn Outer Silver inner conductor
- Various Gas Voltage Capsule available depending on system RF Power.



Voltage Protection	V=	Frequency Range VSWR (loss)	Capsule Protector
			Benelec #
90V		$0 \leq f \leq 1 \text{ GHz}$ $\leq 1.06 (0.0037\text{dB})$	176901
230V			176902
350V			176903
600V		$0 \leq f \leq 2.5 \text{ GHz}$ $\leq 1.2 (0.036\text{dB})$	176904
800V			176905
1000V			176906

Fixed adaptor, Nfemale – Nfemale
Bulk Head, with EMP protector (gas filled)

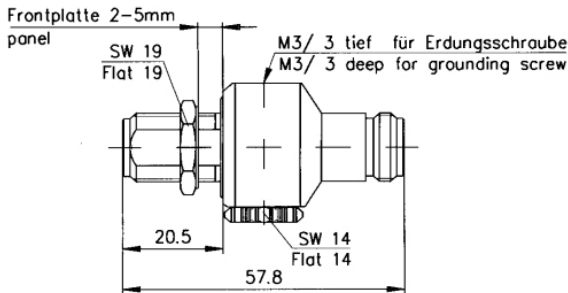
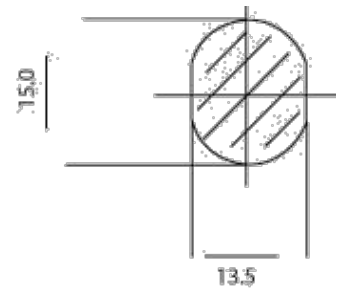

Fig.1

Gas Capsule



Panel Entry Hole



Gas Capsule Selection Chart

Maximum RF Power (CW) Vs System VSWR

Gas Capsule, Spark Over Voltage	1.00 : 1	1.22 : 1	1.5 : 1	3.0 : 1
90 V	28 W	22 W	20 W	12 W
230 V	180 W	150 W	110 W	80 W
350 V	500 W	430 W	320 W	250 W
600 V	1.2 kW	1 kW	800 W	500 W
800 V	1.85 kW	1.55 kW	1.35 kW	800 W
1000 V	2.5 kW	2.1 kW	1.9 kW	1.1 kW

It is important to match the correct Spark over voltage to the power rating of the RF system, this will ensure maximum protection to your transmission equipment. If you require any help with the selection please contact our sales staff at Benelec. You should also be aware that the gas capsule will deteriorate with the level of strikes received. If the system performance noticeably deteriorates then one or more strikes have occurred and the capsule needs to be replaced.

Capsules are relatively low cost hence it is recommended that spares should be kept on site for quick change over and minimum down time.