

DATASHEET

PART NO: **1720013N4**

Load 50 Ohm N Socket DC-6GHz 50w -155dBc

FEATURES

- Wide Frequency Band DC-6GHz
- Excellent Performance in PIM
- Low VSWR
- Indoor & IP65 Rated
- Reliable, Robust & Durable

ELECTRICAL & MECHANICAL SPECIFICATIONS

Frequency	DC-6GHz
VSWR	≤1.40
PIM	-155dBc@2x43dBm
Power Rating	50W (average power)
Impedance	50 ohm
Connector	N Female
Colour	Black-plated
Operating Temp	-25°C to +50°C
Dimensions	See mechanical Drawing
Weight	0.75 KG (approx)

VSWR

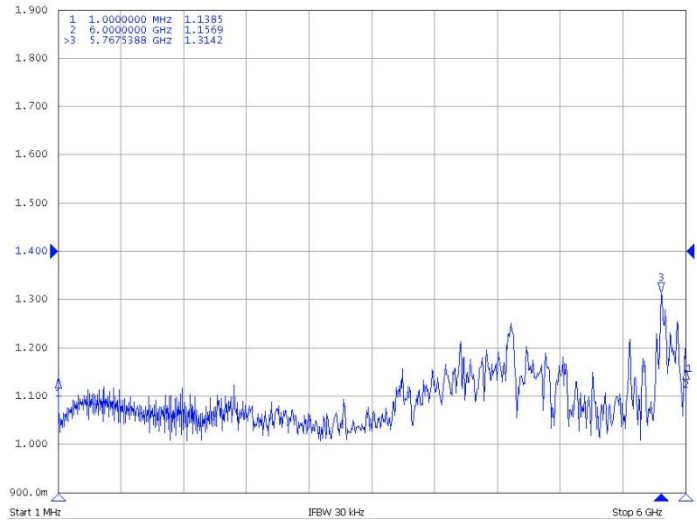

WARRANTY

12 months (Please refer to [Benelec Terms & Conditions](#))

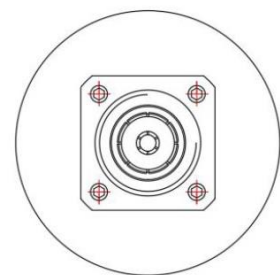
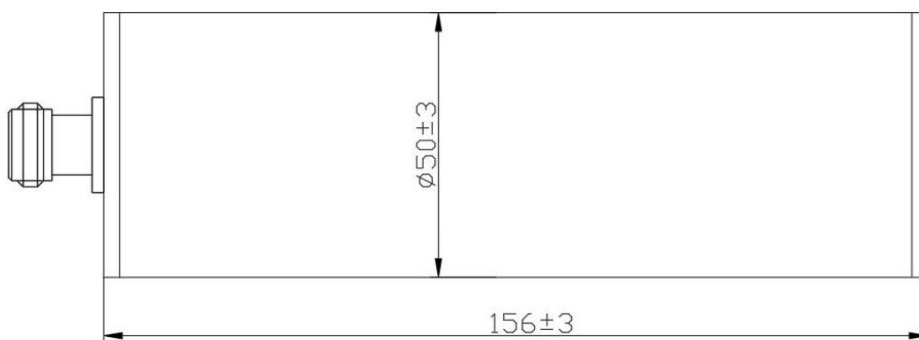

Dimensions in mm